

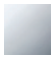

28 796 710



- PURE RAIN, max. flow rate 6.8 l/min (at 3 bar)
- Function from: 6 l/min
- with anti-scale system
- rain shower 300 x 240mm
- distance between ceiling and lower edge of the shower 165mm
- rosette 78 x 55, as required
- 1/2" connection
- quick clearing
- This product reduces water consumption by % (compared to requirements of EPAAct '92)
- This product can contribute to Water Use Reduction in LEED® Green Building Rating
- This product can help a building meet the requirements of Green Building Rating Systems, e.g. LEED®, BREEAM®, DGNB

	Chrome	28 796 710-00 0010
	Brushed Platinum	28 796 710-06 0010

Required miscellaneous

	<b>Concealed wall elbow -</b> •max. recess depth 163 mm •min. recess depth 90 mm	35 085 970-90 0010
-----------------------------------------------------------------------------------	----------------------------------------------------------------------------------------	-----------------------



# LULU Rain shower with ceiling fixing 300 x 240 mm - Chrome

LULU

28 796 710

mm [inches]

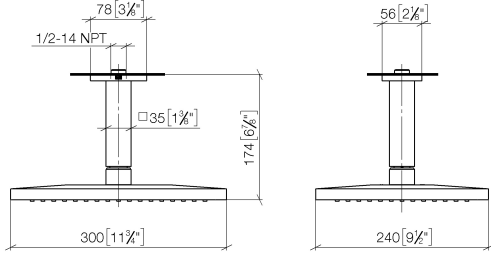

## Flow rate chart

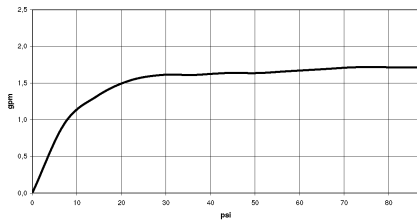

## Codes & Standards

ASME  
A112.18.1/CSA  
B125.1

California Energy  
Commission  
(CEC)

Water Sense





## LULU Rain shower with ceiling fixing 300 x 240 mm - Chrome

---

LULU

28 796 710

### Certificates

---

IAPMO\_11777.

IAPMO\_4976 (4).

28 796 710

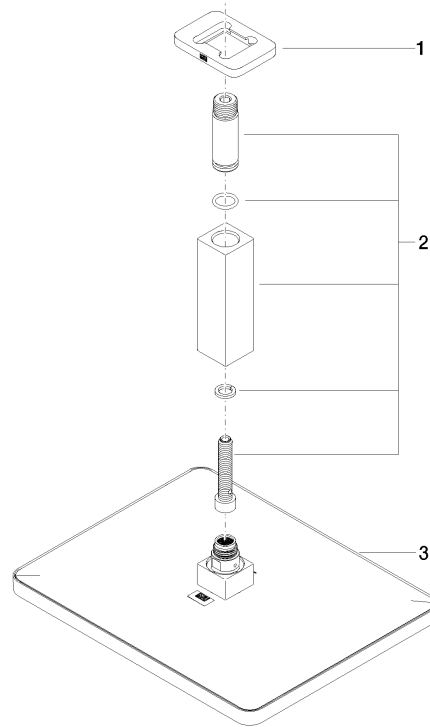

### Spare parts list

No.	Item Number	Name	Quantity used	Delivery time
1	09 27 71 020-00	rosette	1	10
2	90 11 10 092 00-00	connection	1	10
3	04 12 05 062 10-00	shower	1	10